

SPLINE Ⓟ
See datum B

Not in scale

Min. effective	4.987
MAX. effective	5.049
Min. actual	5.047
Max. actual	5.109

INTERNAL INVOLUTE SPLINE DATA	
TYPE:ANSI B92.1-FLAT ROOT SIDE FIT	
NO. OF TEETH	42
SPLINE PITCH	8/16
CIRCULAR PITCH	9.974
NORMAL PRESSURE ANGLE	30°
REFERENCE PITCH DIAMETER	133.35
BASE CIRCLE DIA.	115.484
MAJOR DIAMETER	137.738/137.865
MINOR DIAMETER	130.175/130.302
FORM DIAMETER	136.792
GAP WIDTH	5.047/5.109
DIMENSION OVER TWO PINS(DM=6 h3)	123.954/124.071
BASE TANGENT LENGTH	82.4079/82.461
NORMAL BACKLASH WITH MATING SPLINE	0.231/0.124
TOLERANCES:	
-INVOLUTE PROFILE VARIATION (MAX)	0.017
-INVOLUTE PROFILE VARIATION (MIN)	-0.024
-TOOTH LEAD VARIATION	0.014
-TOTAL INDEX VARIATION	0.078
MATING SPLINE DATA: ANSI B92.1-FLAT ROOT SIDE FIT	

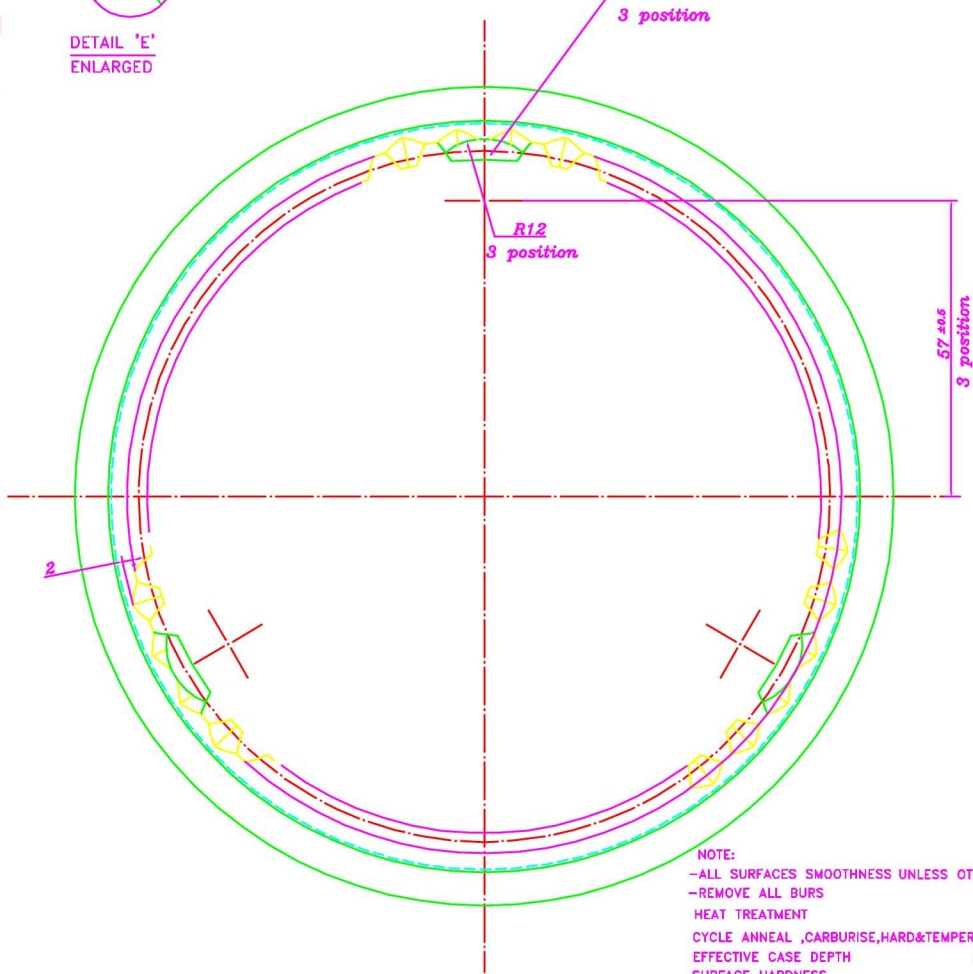
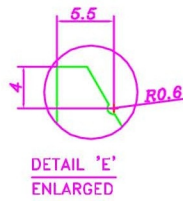
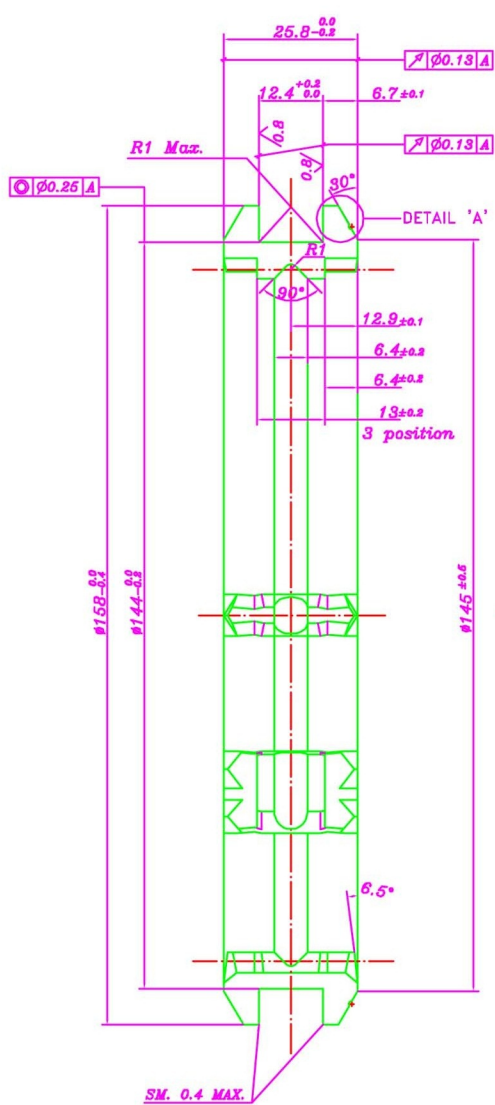
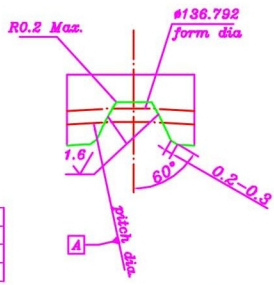

NOTE:
 -ALL SURFACES SMOOTHNESS UNLESS OTHERWISE SPECIFIED 3.2
 -REMOVE ALL BURS
 HEAT TREATMENT
 CYCLE ANNEAL ,CARBURISE,HARD&TEMPER.
 EFFECTIVE CASE DEPTH 0.76-1.15
 SURFACE HARDNESS 58-63HRC
 SURFACE CARBON CONTENT 0.8-1.1%
 CORE HARDNESS 22-43HRC

TOOTH CROSS VIEW ENLARGED

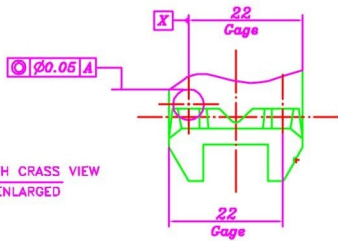

SPLINE Ⓟ
See datum X

Not in scale

Min. effective	5.577
MAX. effective	5.677
Min. actual	5.637
Max. actual	5.737

REFERENCE PITCH DIAMETER	133.35
GAP WIDTH	5.637/5.737
DIMENSION OVER TWO PINS(DM=6 h3)	125.05/125.23
BASE TANGENT LENGTH	82.92/83.00

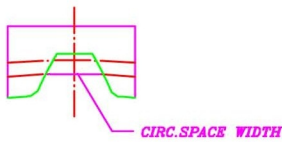

Both of tooth sides chamfering carry out in two setup in one operation

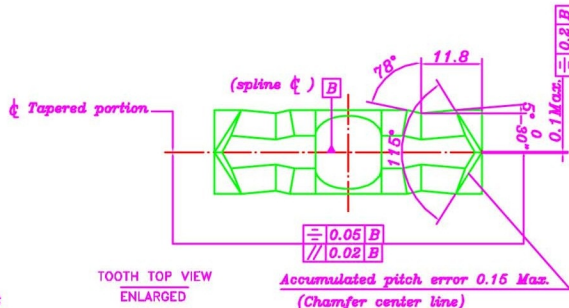

Accumulated pitch error 0.16 Max.
(Chamfer center line)

SDC	Issue	Modification - To Be Modified On CAD				Date	Name
CAD Drawing	Date	Design	Date	Check	Date	Approve	Date
Material SAE 8620H		Heat Treatment		Weight		Scale	
Projection		Customer		Drawing No.			
General Tolerances: ISO 2768 m-K		Description		Type			
						Sheet No.	CAD
							A3